

Demountable Quartz Torches

Avio Torch
Part No. **N0790131**



Demountable design using one-piece quartz tubing for plasma and auxiliary gas flow. Torches without slots are recommended for organic solvents. 1-slot torches are the standard torch for aqueous solutions. 3-slot torches are typically used for organic analysis.

ICP Model	No. of Slots	Part No.
Avio 200/500	1	N0790131
Avio 200/500 Organics (not ceramic)	3	N0790249
8x00 HybridXLT (ceramic tip)	1	N0780128
8x00	0	N0780133
8x00 (Standard)	1	N0780130
8x00	3	N0780132
2x00/4x00/5x00/7x00 DV	0	N0770343
2x00/4x00/5x00/7x00 DV (short ver.)	0	N0770344
2x00/4x00/5x00/7x00 DV	1	N0770338
2x00/4x00/5x00/7x00 DV	3	N0772005
2x00/4x00/5x00/7x00 DV Organics	3	N0772008
4300V/5300V/7300V	3	N0771500
7300 V Organics	3	N0771561
3x00 DV	1	N0691662
3000 SCX/3x00 XL	0	N0695379
3000/3000 SCR/3x00 RL	1	N0690568
3000/3000 SCR/3x00 RL	3	N0681690

Torch Bonnet

The torch bonnet is used as a spacer between the torch and RF load coil.



ICP Model	Part No.
2x00/4x00/5x00/7x00	N0775289

Copper Ignitor Tape



ICP Model	Qty.	Part No.
8x00	50	N0781097*
2x00/4x00/5x00/7x00	120	N0775297

*Ignitor tape for Optima and HybridXLT Torches

Torch Body Assemblies

ICP Model	Part No.
Avio 200	N0790138
Avio 500	N0810128

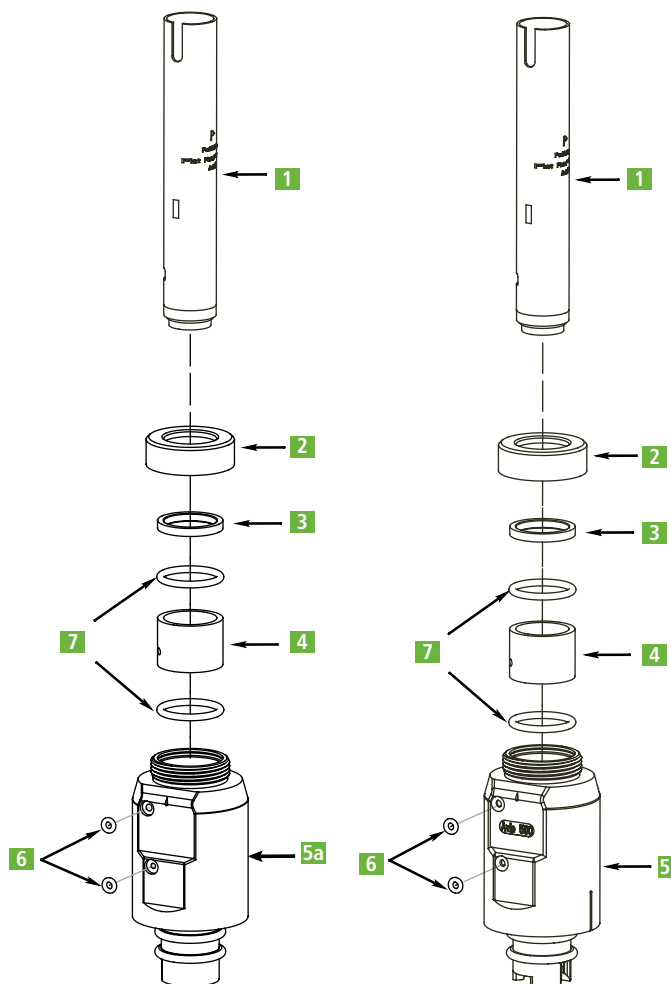

Avio 200 Torch Body Assembly
Part No. **N0790138**

Avio 500 Torch Body Assembly
Part No. **N0810128**

Torch Body Assembly Replacement Parts

Description	Part No.
1 Torch Glass	N0790131
2 Knurled Nut	N0776027
3 Washer	N0776028
4 Spacer	N0791125
5a Cassette for Avio 200 Torch Body Assembly	N0790214
5b Cassette for Avio 500 Torch Body Assembly	N0810214
6 O-Ring Color Coded Blue	N0791334
7 O-Ring	09902223